

2.5 CONNECTING LAN USING RJ45

Insert the LAN connector input pin into the RJ45 connector as shown in the Fig.



2.6 CONNECTING HEADPHONES

Insert the Headphone connector into the 3.5mm stereo jack socket which is at the right side of the terminal as shown in Fig.



2.7 CONNECTING USB Device mini (Type B)

Connect the USB B connector to the USB Device mini (Type B) of the terminal which is at the right side of the terminal as shown in Fig.

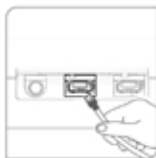

2.8 CONNECTING USB Host mini (Type A)

Connect the USB B connector to the USB Host mini (Type A) of the terminal which is at right side of the terminal as shown in Fig.



Precautions :

1. Change/Charge the battery when it indicates one bar on LCD.
2. For transactions, there should be a minimum of two bars present on the display.

7

3 Operation

3.1 FRONT VIEW LAYOUT



8

3.2 USING CONTACTLESS READER



Fig. holding contact less reader over the LCD of the terminal with hand.

3.3 TROUBLE SHOOTING

SL.No.	Problem	Remedy
01.	Nothing appears on the Display	<ol style="list-style-type: none">1. Check the battery voltage2. Check the contact of the battery voltage.3. Make sure the power cord is properly plugged into power outlet.4. Connect another electrical appliance to the outlet to see if the power from the outlet is present.
02.	Printer Not Working	<ol style="list-style-type: none">1. Check the paper and its position2. Verify the printer cover3. Check the Battery Status

3.4 SPECIFICATIONS

Processor	ARM9 32-bit Core CPU @ 400Mhz
Memory	128 MB RAM (DDR) / 256 MB Flash
Operating System	LINUX 2.6.31
Keypad	31 Backlit Keys
Display	128 x 64 pixel Graphic FSTN LCD with backlight
Printer	Impact graphic printer; 24 column, 144 dots/line; 57 mm (2.25 in) wide paper
Contactless Reader	Card interface: Felica and ISO 14443A/ MIFARE, Supports NFC IP-1
Peripheral Ports	Console Cable * 1x USB Device mini (Type B) 1x LAN (RJ45 connector) 1x USB host mini (Type A) 1x Micro SD card holder for extendable memory size 1x 3.5 mm stereo jack socket
Communications	a) LAN 100 BASE-T (Standard RJ45 connection) * b) GSM / GPRS (SMA female antenna connection)

9

Power Adaptor	9V, 2.2A/3A
Battery	Li-ion 7.4V, 2600mAh
Enclosure	ABS+PC
Operating Temperature	0°C to 55°C
Humidity	95% RH non condensing
Immunity	IEC 61000-4-2, Level 3 IEC 61000-4-3, IEC 61000-4-4, IEC 61000-4-5, IEC 61000-4-6, IEC 61000-4-8, IEC 61000-4-9, all Level 4
Safety	CE Certified
Dimensions (mm x mm x mm)	253 L x 100 W x 76 H
Weight	785 grams

* Indicates Optional Features

NOTE : DO NOT THROW THE BATTERIES INTO THE DUST BINS, FIRE AND IN OPEN AREAS. PLEASE DISPOSE THEM IN ENVIRONMENT FRIENDLY MANNER.

3.5 WARRANTY

VISIONTEK 93 POS is warranted for a period of 12 months from the date of invoice against manufacturing defects. Printer and Battery are warranted for 6 months. Consumer durables don't have any warranty. Linkwell Telesystems Pvt. Ltd. obligation under this warranty shall be limited to servicing or replacing the defective parts provided that notice of such defects and satisfactory proof there of is given to Linkwell Telesystems Pvt. Ltd. The warranty does not cover any defect in the product caused by accident, misuse, mishandling, negligence, alteration, modification or substitution of any of the components or parts or any attempt at internal adjustments, any form of tampering by unauthorized / unskilled service personnel, loss of components or accessories, natural calamities and over voltage of electricity.

Under no circumstance shall Linkwell Telesystems Pvt. Ltd. be liable for any consequential or resulting injury or for loss, damage or expenses directly or indirectly arising from the use of this product Linkwell Telesystems Pvt. Ltd will make every effort to carry out repairs/replacement under this warranty as early as possible and it is expressly made clear that the company shall not be liable to do so within any specified time or period.

The decision of Linkwell Telesystems Pvt. Ltd as to the nature of the defect and applicability of this warranty shall be final. Claims if any, to this warranty shall be only made before the courts having jurisdiction in Secunderabad, Andhra Pradesh.

3.6 93 POS VARIANTS



Linkwell Telesystems Pvt. Ltd.

1-11-252/1/A, Gowra Klassic, Begumpet, Hyderabad - 500 016, Andhra Pradesh, INDIA.
Ph. : +91-40-66388000 | Fax : +91-40-66388006, 27763838

info@visiontek.co.in | www.visiontek.co.in

BRANCHES:

AHMEDABAD - 079-40062001/02 | BANGALORE - 080-25598811 | CHENNAI - 044-24797950/60 |
KOLKATA - 033-22176549 | MUMBAI - 022-24916940/42 | NOIDA - 0120-4281114 | VIZAG - 0891- 2508088

www.visiontek.co.in

VISIONTEK



User's Manual 93 POS

Congratulations !!! We thank you for purchasing the VISIONTEK- 93 POS terminal. This User's manual will help you in knowing all the features of the system including installation, Operational and installation procedure in a step by step manner. Please keep this handy manual for easy reference.

Note: The specific options are factory configured as per your order. Parts of this manual pertaining to other variants and options may not be applicable to your particular VISIONTEK 93 POS terminal.

- 1 Introduction
- 2 Installation
- 3 Operation

1 Introduction

It is designed around a powerful ARM9 32-bit processor with 400MHz running a standard Linux operating system integrated with Impact Printer, Graphic LCD and a choice of contemporary connectivity options.

The high capacity Lithium-ion battery pack and special emphasis on power management makes the VISIONTEK 93 POS one of the most versatile terminals for deployment across diverse application scenarios, whether fixed location or mobile environments.

1.1 IMPORTANT SAFETY INFORMATION

To protect yourself and your VISIONTEK 93 POS terminal against electrical shock, fire, power surges and other risks follow all pre-cautions while using.

1.1.(A) INSTRUCTIONS AND CAUTIONS:

- Never install the VISIONTEK 93 POS terminal in the following places:
 - Exposed to direct sunlight, Moist, hot or dusty
 - Avoid to take the printout on unstable or vibrating surface it may create printing defects
 - Near flammable liquid or gas
 - Near large appliances Viz. A.C, Fridge etc.
 - Near electric apparatus such as radios and TVs
 - Near magnetic bodies such as audio speakers
- Avoid using the terminal during lightning storms
- Do not use liquid or aerosol cleaners for cleaning
- Do not disassemble or modify your 93 POS unit
- Do not open the cover of the 93 POS terminal during operation
- Do not expose the terminal to metal particles
- Do not yank the power cord or place anything on the power cord
- Do not pull the power plug with wet hands
- Do not short or tamper with battery pack gold contact tabs during handling
- Do not try to charge the battery on other chargers
- Do not expose to the rain (or) water

Note: Do not tamper or remove any stickers on the VISIONTEK 93 POS terminal. It may void the warranty on the unit and weaken tamper detection.

2

1.1.(B) CONTENTS OF SHIPPING CARTON

When you unpack the shipping carton, you should find:

- VISIONTEK 93 POS terminal with battery pack - Fig. 1a
- Printer Paper Roll - Fig. 1b
- Console Cable - Fig.1c
- USB Standard A to USB Mini B; USB Standard A receptacle to USB Mini A- Fig.1d
- DC Adaptor - Fig.1e



Fig. 1a

Fig. 1b

Fig. 1c

Fig. 1d

Fig. 1e

2 Installation

2.1 HANDLING OF BATTERY PACK & CONSOLE CABLE

Battery removal: Pick up the unit and turn it bottom up to see the battery pack and gently press the spring latch towards the battery and lift the battery pack out of the unit.

Battery insertion: Insert the battery pack rear tabs first into the terminal then gently swing down the spring latch end and press it into the unit.

Console Cable insertion: Insert the Console cable into the specified connector.

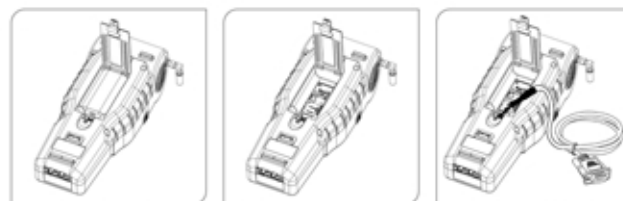

Step 1 Remove the battery pack

Step 2 Install new battery if required

Step 3 Console Cable insertion

3

2.2 CONNECTING THE DC ADAPTOR

Insert the DC Adaptor's 9V DC output cable into the terminal's DC power connector socket.

Plug the DC power adaptor's mains power plug into a standard AC 220V, 50Hz / 110V, 60Hz wall socket.

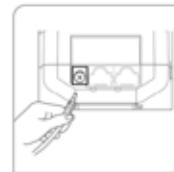

Note: Even if the unit is not switched ON the battery pack in the unit will be charged when ever the DC Adaptor power is available

2.3 SWITCHING ON THE UNIT

Power Switch

- The power ON/OFF switch is on the keypad right hand top corner in red color as shown in the figure above.
- To power up the terminal, press the button and release.
- To power it OFF again, press the button and release

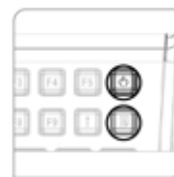

2.4 LOADING THE PAPER ROLL

- Unlock the printer cover, and then rotate the cover towards top side and open it.



4

- Place a roll (35 mtr.) in its housing as shown in the fig. below



- Insert the paper into the slot and press "Paper Feed" key.
- The paper will feed automatically

Guideline for Procurement of Paper Roll

Recommended specifications for Paper Roll			
Outside diameter	Paper roll Width	Bobbin Inner dia	Weight (gm)
60-62 mm	57.5 mm +/-0.5	13-15 mm	Max.127g

- Paper Supplying Load**
Paper Supplying Load in printer paper entrance : 30g or less
- Recommended paper**
Single paper : 45 to 55kg/1,000 sheets/1,091 x 788mm (Thickness 0.06 to 0.085)
Copying paper : Don't use Carbon Paper between
Upper paper (0.065mm thickness / 47GSM)
Lower paper (0.058mm thickness / 47GSM)
- Paper Winding**
Condition of Rolled paper winding start (inner side edge)
 - No fold and along by inner diameter . (ref. under fig.)
 - No flap
 - No paste with paper core (in case of rolled paper with core)
 - Use of cello tape either at paper end or start is not recommended.

5

Wind Starting Position



Since the printer uses permanent magnet (in the motor) and electromagnet (Solenoids) it should not used in location where metallic particles or high level dust and other contamination exists.

- Guidelines for uses of Paper Roll**
 - Use the paper without crease, rent etc.
 - Use the paper without perforation or hole in the print area.
 - Pull the paper slowly and straight.
 - For smoothing to set rolled paper, cut edge of paper obliquely.
 - Use of paper roller Shaft reduces load on the Printer and prevents its damage.
 - Rolled paper should be set with inner curl, not outer curl.
 - Never Pull the paper backwards.
 - Do not touch the knob for paper feeding in the print operation
- Ribbon cassette :**
Ribbon should be in tightened position before inserting into the paper. It is desirable to mount the ribbon cassette after removing the paper.



Note :

- The printer's warranty is based assuming 100 daily prints, each of 40 lines @ 180days or 1.5 million characters.
- Use recommended Ribbon Cartridge.
- Do not replenish ink to the ink ribbon.

6